



818.767.7210 OFFICE | 888.979.6123 FAX
 12863 San Fernando Road | Sylmar CA 91342
 lioherpacific@gmail.com | sales@liopac.com
 WWW.LIOHERPACIFIC.COM

PRODUCTION TIME:
10-14
 BUSINESS DAYS
 FROM DEPOSIT

Client Quote Request
CABINETY PARTS

UPPERS
 ORDER PG 1 OF 2

PAGE _____ OF _____
 TL PGS _____

PAID

Order Date

SALESPERSON

**ALL CABINETY PARTS WILL BE PROVIDED IN WHITE MELAMINE.
 QUOTING FOR OTHER COLOR FINISHES -
 ONLY UPON REQUEST AS UPGRADE.**

IN ORDER TO PROCESS YOUR CABINETY QUOTE, PLEASE SELECT SIZES WITH QUANTITY. WE WILL REPLY WITH PRICING WITHIN 4-7 DAYS FROM RECEIPT.
PLEASE EMAIL
 LIOHERPACIFIC@GMAIL.COM

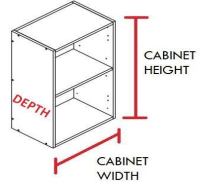

IMPORTANT DETAILS:

Finished doors, drawer fronts, hole boring and mounting hardware are excluded | All hardware (hinges, brackets, shelf supports, drawer boxes, drawer slides and pull-out accessories) are excluded | Cabinetry parts provided in white melamine. (Other colors options provided as additionally priced upgrades). | Interior shelves are provided in white melamine (Shelf supports are excluded).

WALL UPPER CABINETS

STANDARD WALL		Cabinety Heights from 12" - 42" Tall											
Width	Depth	12" H	15" H	18" H	21" H	24" H	27" H	30" H	33" H	36" H	39" H	42" H	
STANDARD WALL CABINETS	12"	12"D	W1212	W1215	W1218	W1221	W1224	W1227	W1230	W1233	W1236	W1239	W1242
	18"	12"D	W1812	W1815	W1818	W1821	W1824	W1827	W1830	W1833	W1836	W1839	W1842
	21"	12"D	W2112	W2115	W2118	W2121	W2124	W2127	W2130	W2133	W2136	W2139	W2142
	24"	12"D	W2412	W2415	W2418	W2124	W2424	W2427	W2430	W2433	W2436	W2439	W2442
	27"	12"D	W2712	W2715	W2718	W2721	W2724	W2727	W2730	W2733	W2736	W2739	W2742
	30"	12"D	W3012	W3015	W3018	W3021	W3024	W3027	W3030	W3033	W3036	W3039	W3042
	33"	12"D	W3312	W3315	W3318	W3321	W3324	W3327	W3330	W3333	W3336	W3339	W3342
	36"	12"D	W3612	W3615	W3618	W3621	W3624	W3627	W3630	W3633	W3636	W3639	W3642
	39"	12"D	W3912	W3915	W3918	W3921	W3924	W3927	W3930	W3933	W3936	W3939	W3942
	42"	12"D	W4212	W4215	W4218	W4221	W4224	W4227	W4230	W4233	W4236	W4239	W4242
48"	12"D	W4812	W4815	W4818	W4821	W4824	W4827	W4830	W4833	W4836	W4839	W4842	

ABOVE REFRIGERATOR		12" H	15" H	18" H	21" H	24" H	
DEEP REF WALL CABINETS	24"	24"D	REF2412	REF2415	REF2418	REF2421	REF2424
	27"	24"D	REF2712	REF2715	REF2718	REF2721	REF2724
	33"	24"D	REF3312	REF3315	REF3318	REF3321	REF3324
	36"	24"D	REF3612	REF3615	REF3618	REF3621	REF3624
	39"	24"D	REF3912	REF3915	REF3918	REF3921	REF3924
	42"	24"D	REF4212	REF4215	REF4218	REF4221	REF4224
48"	24"D	REF4812	REF4815	REF4818	REF4821	REF4824	

Directions:

Select parts needed by locating box w desired part number below. Write in the count of the units needed within the boxes below. We will then create a list of your requested items and return pricing for your consideration. When you choose to proceed, an invoice will be issued for your approval and deposit to initiate production of your order. We provide Clients with 2 lists to create an order for upper and base cabinetry with the available parts we provide.

For example, if you need 3 units of upper 42"Wx12"H, locate code as W4212. THEN ENTER AS:

EMAIL: LIOHERPACIFIC@GMAIL.COM

ITEMS FOR "ABOVE REFRIGERATOR" (SEE LEFT)
 THESE ITEMS HAVE 24" CABINET DEPTHS.
 IDEAL CABINETS FOR ABOVE REFRIGERATION APPLIANCES TO
 ACHIEVE CUSTOM BUILT IN APPEARANCE